

# Giant Ledge Panther Dates

9/18/10

last ascent 5/21/87

170-33

Look for: (over)

- ① Bazzana Bump old hemlocks & suggest to Roger Wall
- ② N Spr Panther Spruce
- ③ Measure area of fern glade in Giant Ledge - Panther col & determine whether it is shrinking or expanding

④ Look for entry of Campyloptera

⑤ Is Panther a fir mantain with a few spruce? Is spruce distributed throughout or in groves only?

⑥ Look for lookout to SW on Giant ledge

Trail built 1935 fall over Panther Mtn.

Giant Ledge 1954 + 1967 built, 1985 removed  
Lean to between

Fox Hollow lean to 1936

town road Shandaken-Denning 1880s built hiking trail by 1935 in use

1980 new trailhead on the harp

CCC-built Ski slope above Fox Hollow

Woodland Valley Campground 1926 opened

See p 170  
5/15/70  
± 100 x 50'  
Transect # 19

from Winnick

See 1920 SMY Land List p. 275 ff & 288

170-34

between 1924 & 1938, actually 1932  
3360' Pinnacle

between 1911 & 1924  
1902 PRATHER  
JOHNA LIVINGSTON SHERWOOD OR PETER R. LIVINGSTON TRACT

Robert L. Livingston Tract

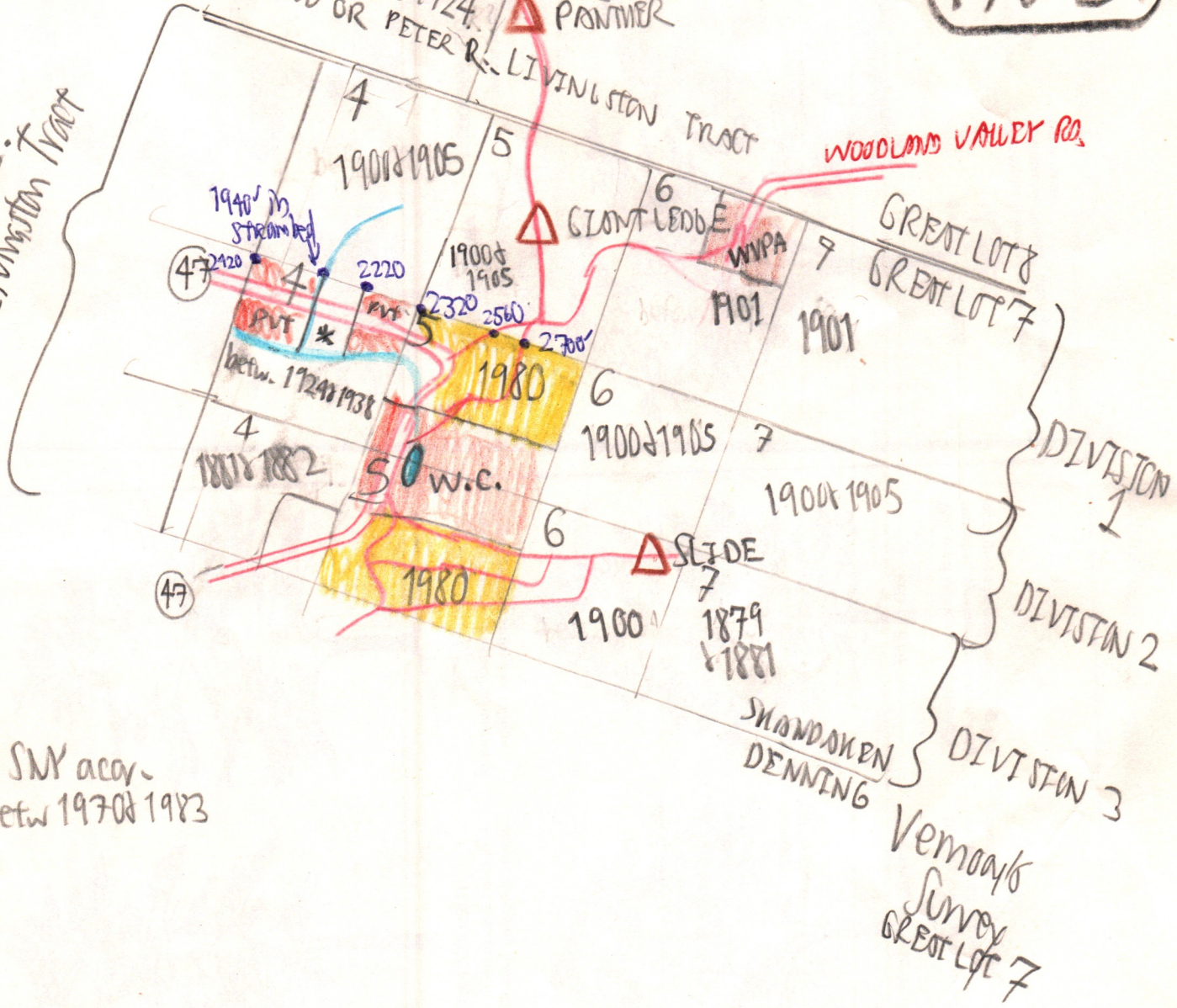

\* SMY acy. betw 1970 & 1983

Vemoay's Survey GREAT LOT 7